

CMCP5019 19" Rack-Mounted Retrofit 10-Channel Monitor



offers an integrated solution to make replacement simple and easy.

The CMCP5019 10 Channel Monitor is precisely designed for direct and simple replacement of antiquated rack mounted monitoring systems. The CMCP5019 mounts in any 19" EIA rack, or can be panel mounted in a cutout. At 19" wide, 7" (2 DIN) high and 7.5" deep the unit is compact, while remaining feature rich. As with any CMCP500 Series System, the CMCP5019 can be stacked for unlimited channel counts.

Outputs Include:

- Common Relay Outputs:
OK, Alert, and Danger
- 4-20 mA Recorder Outputs
- Buffered Dynamic Signal Output
BNC and Terminal
- Optional Digital Communications using
Modbus RS-485 or Modbus TCP (Ethernet)

Features:

- 19" EIA Rack or Panel Mount - 2 DIN High
- Individual Bright Red LED Displays
- OK, Alert, and Danger Relays
Meets API-670
- CE Approved
- Terminals for Customer Wiring
- 110 or 120 VAC Power, 50 or 60 Hz
- Optional -24 VDC Power Supply for Eddy Probes
- Optional Digital Communication
(Modbus RS-485 or TCP)

Dimensions:

- Overall - 19" W x 7" H x 7.5" D
(48.2 x 17.8 x 19 cm)
- Weight - 11 lbs w/Digital Communications
(5 kg)
- Cutout Size - 17.75" x 7"
(45.1 x 17.8 cm)

Installation Is Simple and Straight Forward:

Existing wiring is removed from the monitoring system and terminated on the replaceable terminals on the back panel of the CMCP5019. Power is provided by an integral 24 VDC power supply that accepts 110 or 220 VAC, 50 or 60 Hz. With the use of the front accessible selector switches and the local displays, Current Value, Alert Set Point, and Danger Set Point can be viewed and easily changed.

If replacing a monitoring system with less than 10 channels, blank CMCP500 Series Monitors and Displays will be provided for the unused positions. Additional channels can be added at a later date as the CMCP5019 is pre-wired for all 10 positions.

Condition Monitoring Custom Products

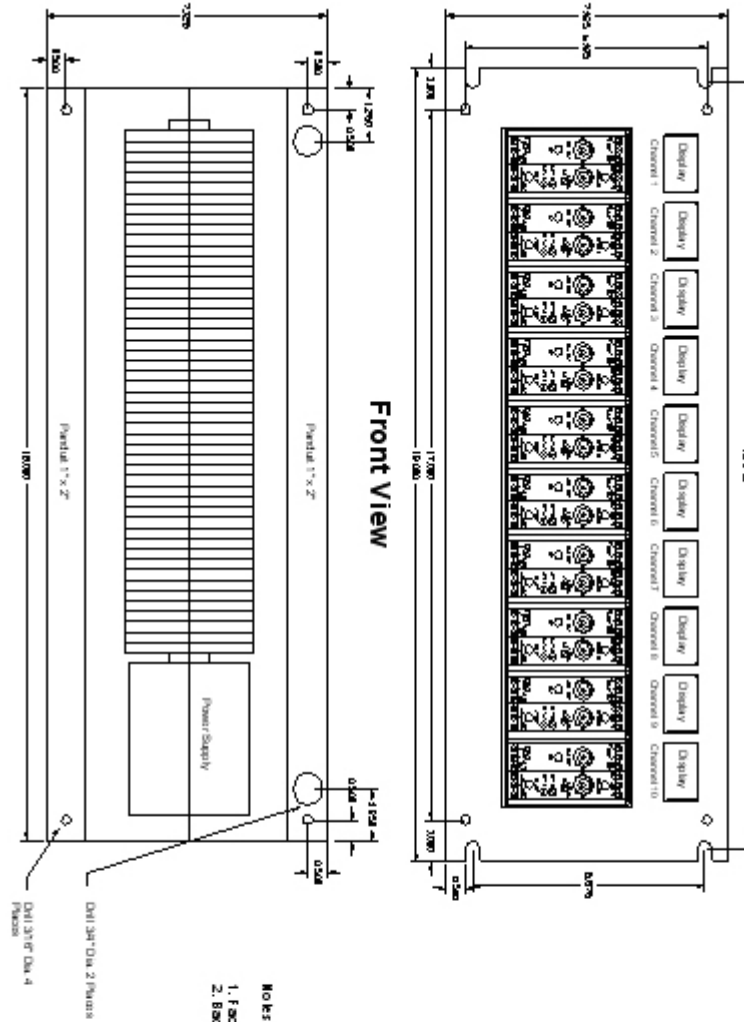

Front View

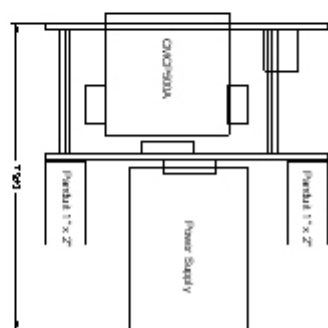

Side View

- NOTE:**
1. Faciate Blue Anodized 18\"/>



STI Vibration Monitoring Inc.

Vibration Monitoring and Machine Protection Systems

1010 East Main Street, League City, TX 77573 Phone:281.334.0766 Fax: 281.334.4255
www.stiweb.com / www.stiwebstore.com

Condition Monitoring Custom Products

CMCP5019 19" Rack-Mounted Retrofit 10-Channel Monitor

Ordering Information:

1. One (1) CMCP5019 10 Channel Monitor
2. Select the channel count (1-10)
3. Select communication option
4. Select a -24 VDC power supply if required for eddy probes
5. Itemize the CMCP500 series monitors in the order (left to right) they will be installed.
We will determine display values from the monitor part numbers.

CMCP5019	-XX	-XX	-XX	10 Channel Rack Mounted Monitor
	-01			1 Display, 9 Blanks
	-02			2 Displays, 8 Blanks
	-03			3 Displays, 7 Blanks
	-04			4 Displays, 6 Blanks
	-05			5 Displays, 5 Blanks
	-06			6 Displays, 4 Blanks
	-07			7 Displays, 3 Blanks
	-08			8 Displays, 2 Blanks
	-09			9 Displays, 1 Blank
	-10			10 Displays
		-00		No Digital Communication
		-RS		Modbus RS-485
		-ET		Modbus TCP (Ethernet)
			-00	Without -24 VDC Aux. Supply
			-24	With -24 VDC Aux. Supply

To Order Online Please Visit
www.stiwebstore.com