

3 Pin MS Connector
Vibration and Temperature Output Sensors

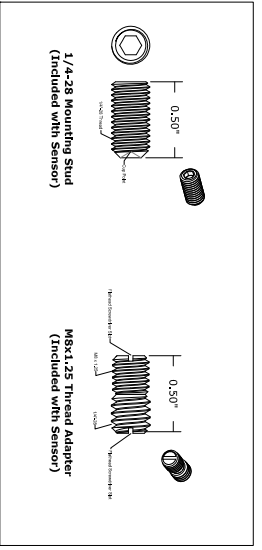
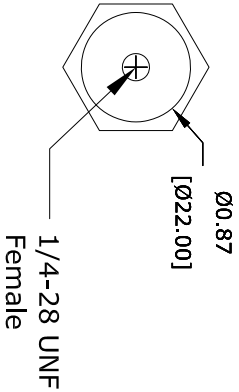
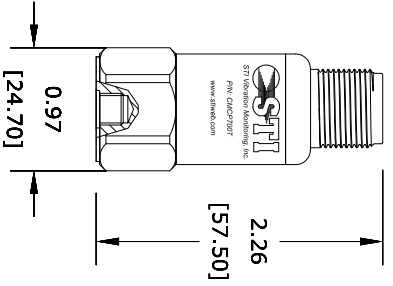
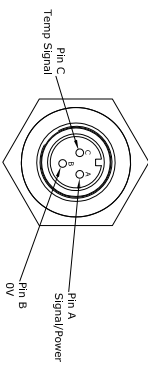

THIS DOCUMENT IS PROPERTY OF STI AND SHALL BE USED ONLY FOR THE PURPOSES SPECIFIED OR USED IN THE DRAWING. IT IS TO BE KEPT IN THE ORIGINAL FORM AND NOT REPRODUCED OR TRANSMITTED IN ANY FORM OR BY ANY MEANS, ELECTRONIC OR MECHANICAL, INCLUDING PHOTOCOPYING, RECORDING, OR BY ANY INFORMATION STORAGE AND RETRIEVAL SYSTEM.

| REV | DATE | BY | DESCRIPTION |
|-----|------|----|-------------|
| 1 | | | |
| 2 | | | |
| 3 | | | |
| 4 | | | |
| 5 | | | |

| | | | |
|-------------------------------|--|---------------------------------|--|
| CUSTOMER | | STI Vibration Monitoring | |
| LOCATION | | League City, Texas | |
| ORDER NO. | | CMCP700T Series | |
| UNLESS OTHERWISE SPECIFIED | | TOP FINISH, 3 MS 5015 Connector | |
| ALL DIMENSIONS ARE IN INCHES. | | Scale: 1:1 | |
| TOLERANCES: | | AS SHOWN | |
| FRACTIONS ± .005 | | DECIMALS ± .001 | |
| ANGLES ± 1.0 | | HOLE POSITION ± 0.005 | |
| DATE: 11/17/2022 | | DRAWN: M. HARRIS | |
| CHECK: M. HARRIS | | DATE: 11/17/2022 | |
| APPR: M. HARRIS | | DATE: 11/17/2022 | |
| REV: A | | REV: A | |
| SHEET: 1 OF 1 | | SHEET: 1 OF 1 | |

STI Vibration Monitoring
League City, Texas

A

A