



## CMCP200 Series Mounting Pads and Magnetic Targets



### Features

- Assures Accurate Measurements
- Smooth Finish
- Different Sizes
- 316 Stainless Steel Pads
- 416 Stainless Steel Targets
- Thru-hole, Partially Threaded or Not Threaded

### Typical Applications

Accelerometer Mounting Pads are used to provide a quality surface to mount Accelerometers. By ensuring a smooth surface and perpendicular mounting hole for the Accelerometer, they improve the sensor's frequency response and repeatability of data collection. Accelerometer Mounting Pads may be either stud mounted, or epoxy mounted to the prepared area of the machine's bearing housing. Mounting Pads without holes may be mounted as place markers for Portable Data Collection to ensure location repeatability and quality data trending.

### Permanent Mounting Pads

Fully Threaded for Stud Mounting				
				
<b>Part Number</b>	CMCP200-01	CMCP200-01-M8	CMCP200-02	CMCP200-02-M8
<b>Material</b>	316 Stainless Steel		316 Stainless Steel	
<b>Diameter</b>	1.0" (25.4 mm)		1.0" (25.4 mm)	
<b>Height</b>	0.25" (6.35 mm)		3/8" (9.53 mm)	
<b>Mounting Hole</b>	1/4-28 UNF 2B	M8x1.25	1/4-28 UNF 2B	M8x1.25

### Dimensions

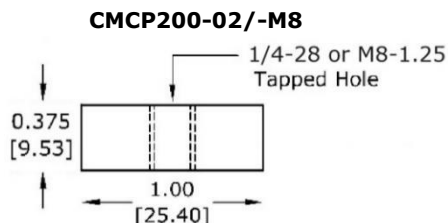
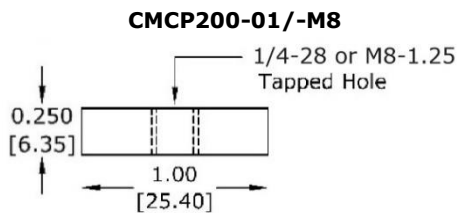

### Select-M6 version for M6x1.0 Threaded Holes

Cementing Pad	
	<p><b>Material</b> 316 Stainless Steel</p> <p><b>Diameter</b> 1.0" (25.4 mm)</p> <p><b>Height</b> 0.375" (9.53 mm)</p> <p><b>Thick</b> 0.2" (5.04 mm)</p> <p><b>Mounting</b> 1/4-28 UNF Stud</p>
<b>Part Number</b>	CMCP200C

	Partially Threaded for Adhesive Mounting		Isolated Mounting Bases	
				
<b>Part Number</b>	<b>CMCP200E</b>	<b>CMCP200E-M8</b>	<b>CMCP200I</b>	<b>CMCP200I-M8</b>
<b>Material</b>	316 Stainless Steel		316 Stainless Steel with Delrin Insulator	
<b>Diameter</b>	1.0" (25.4 mm)		1.0" (25.4 mm)	
<b>Height</b>	0.25" (6.35 mm)		0.625" (15.88 mm)	
<b>Mounting Hole</b>	¼-28 UNF 2B	M8x1.25	¼-28 UNF 2B	M8x1.25

**Dimensions: CMCP200E/-M8**

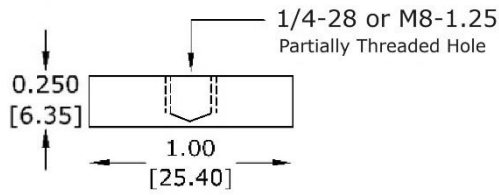

**CMCP200I/-M8**

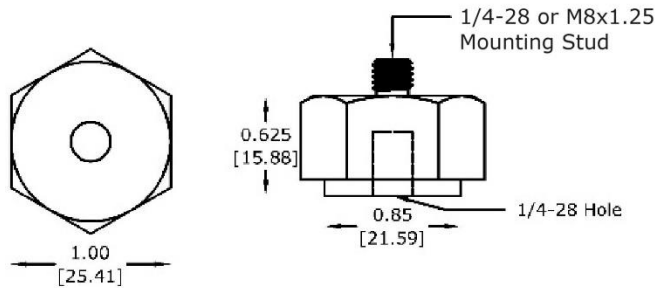

**Features**

- 316 Stainless Steel Construction
- For ¼-28 Sensors
- Isolates Sensor from Machine Case
- Isolates up to 2,000 Volts
- Ensures Accurate Measurements

	Ferrous Pads for Use with Magnetic Sensor Bases			Small, Non-Ferrous
				
<b>Part Number</b>	<b>CMCP200M-01</b>	<b>CMCP200M-02</b>	<b>CMCP200MP</b>	<b>CMCP200S-01</b>
<b>Material</b>	416 Stainless Steel	416 Stainless Steel	416 Stainless Steel	316 Stainless Steel
<b>Diameter</b>	1.0" (25.4 mm)	1.0" (25.4 mm)	1.0" (25.4 mm)	0.75" (19.05 mm)
<b>Height</b>	0.25" (6.35 mm)	3/8" (9.53 mm)	0.25" (6.35 mm)	0.25" (6.35 mm)
<b>Mounting Hole</b>	¼-28 UNF 2B	¼-28 UNF 2B	Flat Target	¼-28 UNF 2B

**Protective Caps  
CMCP200C-01**



**Features**

- Protects Against Paint and Debris
- Provides Damage Protection
- Packs of 25, 50 and 100
- For 1.0" (25.4mm) Diameter Pads

**Ordering Information:**

CMCP200C-01-05	Pack of 5
CMCP200C-01-10	Pack of 10
CMCP200C-01-50	Pack of 50
CMCP200C-01-100	Pack of 100
CMCP200C-01-250	Pack of 250