



Condition Monitoring Custom Products

CMCP4190 Eddy Probe Mounting Adapter



CMCP offers the CMCP-4190 for probe installations where the shaft is only a short distance from the bearing housing. The probe adapter is a 1/2" or 3/4" NPT threaded on either end for mounting to the housing, and a conduit head. The CMCP4190 is manufactured from Stainless Steel. The ID thread is available to fit the 2 common eddy probe thread sizes. For particularly long probes an optional deep conduit head is available.

Part#	OD Thread	ID Thread	"A"	"B"
CMCP4190-01	1/2" NPT	1/4" x 28 UNF	1.50"	0.625"
CMCP4190-02	1/2" NPT	3/8" x 24 UNF	1.50"	0.625"
CMCP4190-03	3/4" NPT	1/4" x 28 UNF	1.81"	0.750"
CMCP4190-04	3/4" NPT	3/8" x 24 UNF	1.81"	0.750"

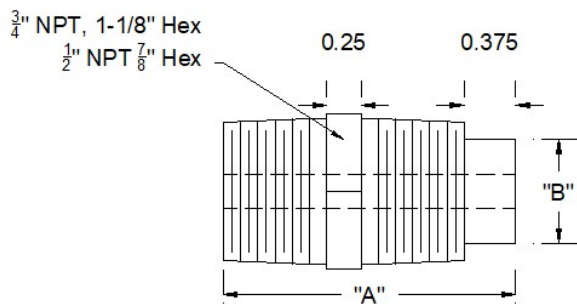

CMCP Part Number				
CMCP4190	-XX	O.D.	I.D. Thread	Total Length
	01	1/2" NPT	1/4" x 28	1.50"
	02	1/2" NPT	3/8" x 24	1.50"
	03	3/4" NPT	1/4" x 28	1.81"
	04	3/4" NPT	3/8" x 24	1.81"

To Order Online Please Visit
www.stiweb.com