

Cable Construction (3 Core TPE)

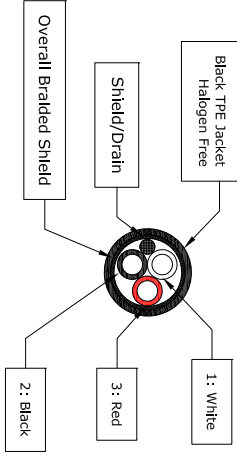

Isolated Shielding (-1 Option)

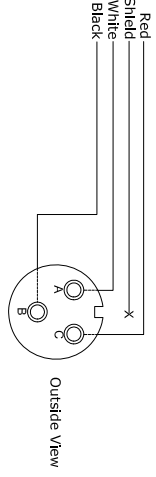

Non-Isolated Shielding (-NI Option)

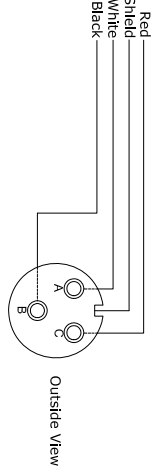

Maximum Cable Bend Radius

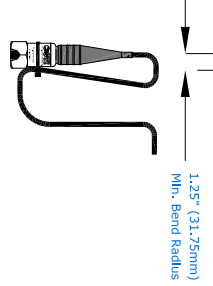

Bottom View

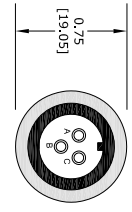

Side View

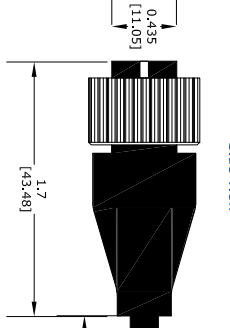

Bottom View

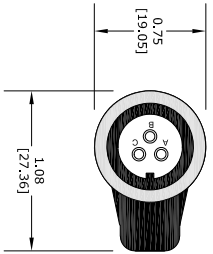

Side View

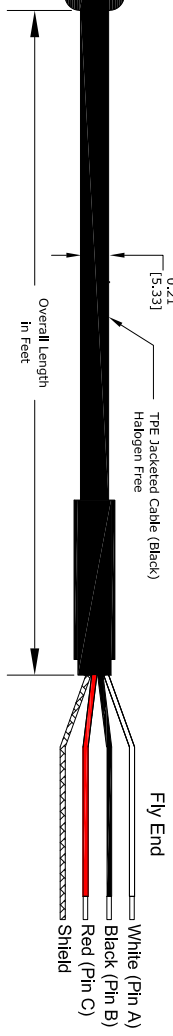
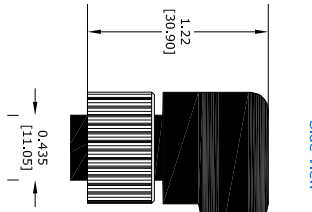

Ordering Information

- CMCP633L-AA-BB-CC
- AA: Specify Cable Length In Feet
  - 16 (16', 5m)
  - 32 (32', 10m)
  - 64 (64', 20m)
- Other - Specify Length In Feet
- BB: Connector Angle
  - 01 Straight Exit
  - 02 Side Exit (90 Degree)
- CC: Shielding
  - 1 (Shield Isolated at Connector, STI Standard)
  - NI (Non-Isolated, Shield Tied to Connector)

THIS DOCUMENT IS THE PROPERTY OF SENSORS INC. AND IS NOT TO BE REPRODUCED OR TRANSMITTED IN ANY FORM OR BY ANY MEANS, WITHOUT PERMISSION IN WRITING FROM SENSORS INC. THIS DOCUMENT IS UNCLASSIFIED AND IS NOT SUBJECT TO EXPORT CONTROL REGULATIONS.

UNLESS OTHERWISE SPECIFIED ALL DIMENSIONS ARE IN INCHES. TOLERANCES: XX ± 0.01 ANGLES ± 1.0 FRACTIONS XX ± 0.01 ANGLES ± 1.0 XXXX ± 0.0005

3 Pin MS Overmolded Plug Polyamide (Nylon) Connector with 316 Stainless Steel Shielding Cable

Halogen Free TPE Cable Maximum Operating Temperature of 120°C. Good Resistance to Harsh Chemicals

Connector Sealed to IP68 When Properly Connected to Sensor

STI Vibration Monitoring League City, Texas

CMCP633L Series Molded Cables

Scale: 1:1

Sheet: 1 of 1

Wire Color Code	Color	Pin
White	White	1
Black	Black	2
Red	Red	3
Shield	Shield	Shield

Ordering Information	Value
AA: Specify Cable Length In Feet	-16 (16', 5m)
BB: Connector Angle	-01 Straight Exit
CC: Shielding	-1 (Shield Isolated at Connector, STI Standard)

Rev	Date	Drawn	Description
1			
2			
3			
4			
5			

Customer Location	Order No.

Customer Location	Order No.

Check	By	Date
Drawn	M. Howard	12/11/2023
Rev	M. Howard	12/11/2023

Part No.	Rev	Scale
CMCP633L DWG	A	1:1